

Note: Rear triangle should fall by itself after assembly!

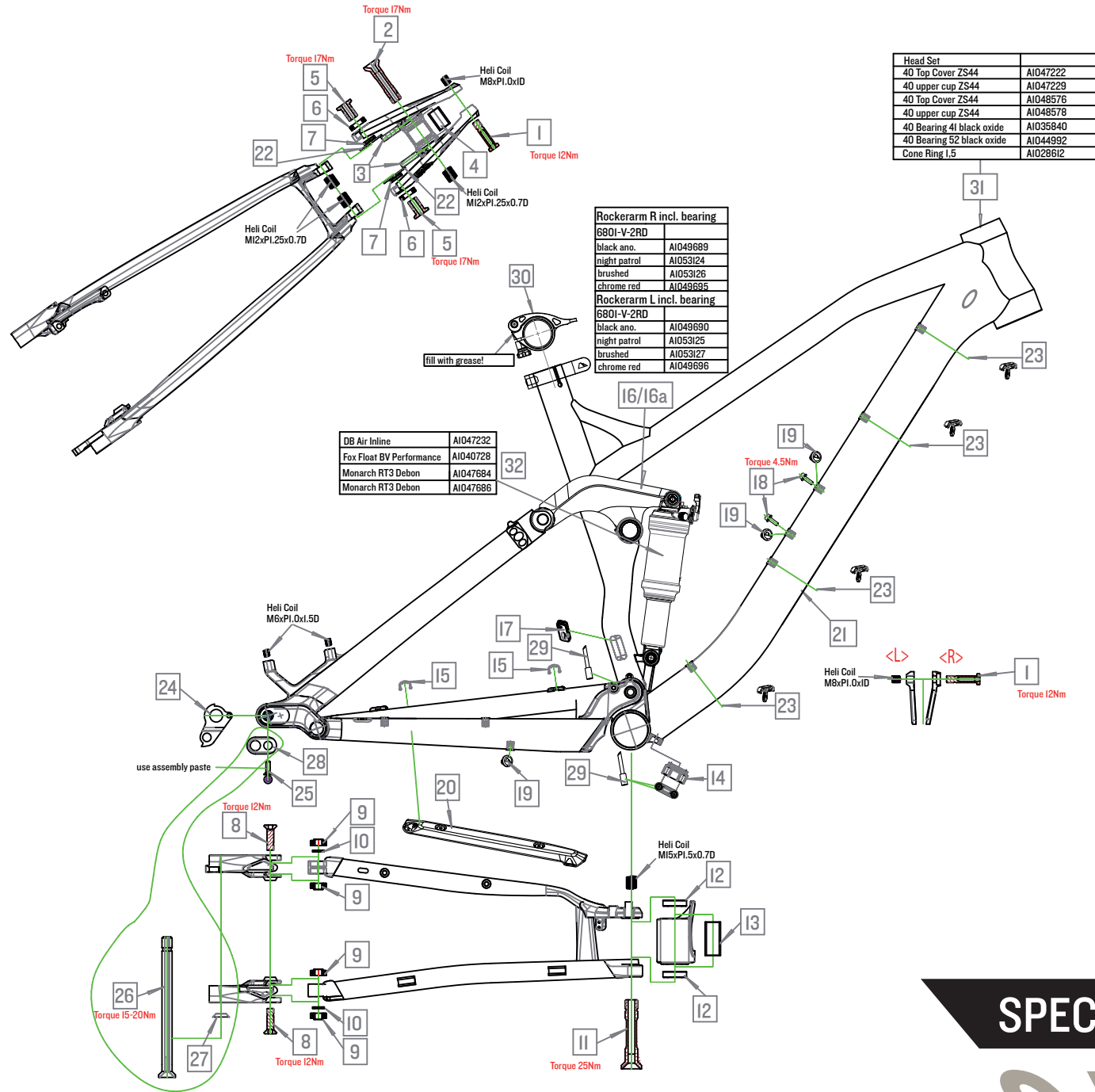

	Canyon#	Part Name	Qty.
1	A1043776	shock bolt	2PCS
2	A1043777	axle for rocker arm pivot	1PC
3	A1035330	bearing 790I-V-2RD	2PCS
4	A1043778	spacer ST-pivot	1PC
5	A1043779	pivot bolt	2PCS
6	A1038902	bearing 680I-V-2RD	2PCS
7	A1043780	pivot spacer	2PCS
8	A1043781	horstlink bolt	2PCS
9	A1043782	bearing 698-V-2RD-1.5	4PCS
10	A1043783	horstlink spacer	2PCS
11	A1043784	main pivot axle	1PC
12	A1029862	bearing 7902-V-2RD	2PCS
13	A1043785	spacer main pivot	1PC
14	A1042777	Cable guide E24-14	1PC
15	A1012043	Cable Clip II-10I-777	2PCS
16	see drawing	Rockerarm R	1SET
16a	see drawing	Rockerarm L	1SET
17	A1028806	clip-in cable guide E99-12	1PC
18	A1033271	water bottle screw	2PCS
19	A1016702	blind plug E40-10	3PCS
20	A1043786	C/S protector incl. screws E170-14	1SET
21	A1043787	protection foil D/T 45x235mm	1PC
22	A1052935	SS-Yoke Pivot washer	2PCS
23	A1049247	double cable-clip E195-14	4PCS
24	A1038695	RD-hanger # 26 for SRAM	1PC
25		incl. screws M5x16mmL	1PC
24	A1038715	RD-hanger # 27 for Shimano direct mount	1PC
25		incl. screws M5x16mmL	1PC
26		Canyon through axle	1PC
27	A1040927	conic steel washer E172-14	1PC
28		D0 chip	1PC
29	A1013141	Jagwire nose ferrule	3PCS
30	A1039573	Seat clamp 30.9/35.0mm black	1SET
31	see drawing	Head Set	1SET
32	see drawing	Rear Shock	1SET

SPECTRAL AL | M17-15

