

rear triangle should fall by itself after assembly!

	Canyon#	Part Name	Qty.
1	A1013161	sleeve	IPC
2	A1013162	spacer	IPC
3	A1022940	spacer	IPC
4	A1013163	screw	IPC
5	A1016890	linkage shock nut	3PCS
6	A1000736	bearing 6902-2RS	2PCS
7	A1013166	retaining ring	IPC
8	A1013167	ISCG 05 plate	IPC
9	A1013168	spacer	IPC
11	A1013172	shock mount screw	IPC
12	A1013173	Torque FRX Swing	IPC
15	A1006673	screw	IPC
16	A1012028	bearing 608-2RS	4PCS
18	A1013175	spacer	2PCS
19	A1013176	spacer	2PCS
20	A1013177	screw	2PCS
21	A1013184	spacer	2PCS
23	A1013178	screw	2PCS
24	A1013179	nut	2PCS
25	A1013180	spacer	4PCS
26	A1013185	joint screw	2PCS
27	A1013186	joint axis	2PCS
29	A1012036	bearing 698-2RS	4PCS
30	A1014498	RD-Hanger #20	IPC
31	A1014498	incl. screws	3PCS
32	A1013164	dust cap	IPC
33	A1013169	screw for ISCG05 plate	IPC
35	A1005111	satellite with bolt	11Sets
36	A1013170	washer	IPC
37	A1017499	Canyon bushing E60-II	4PCS
38	A1014819	protection foil	IPC
39	A1010848	FSA Big Fat Pig 1.5 red. to 1 1/8"	1Set
40	see drawing	Rear Shock	IPC
41	see drawing	Seat Clamp E10-09 31.6/36mm	1Set

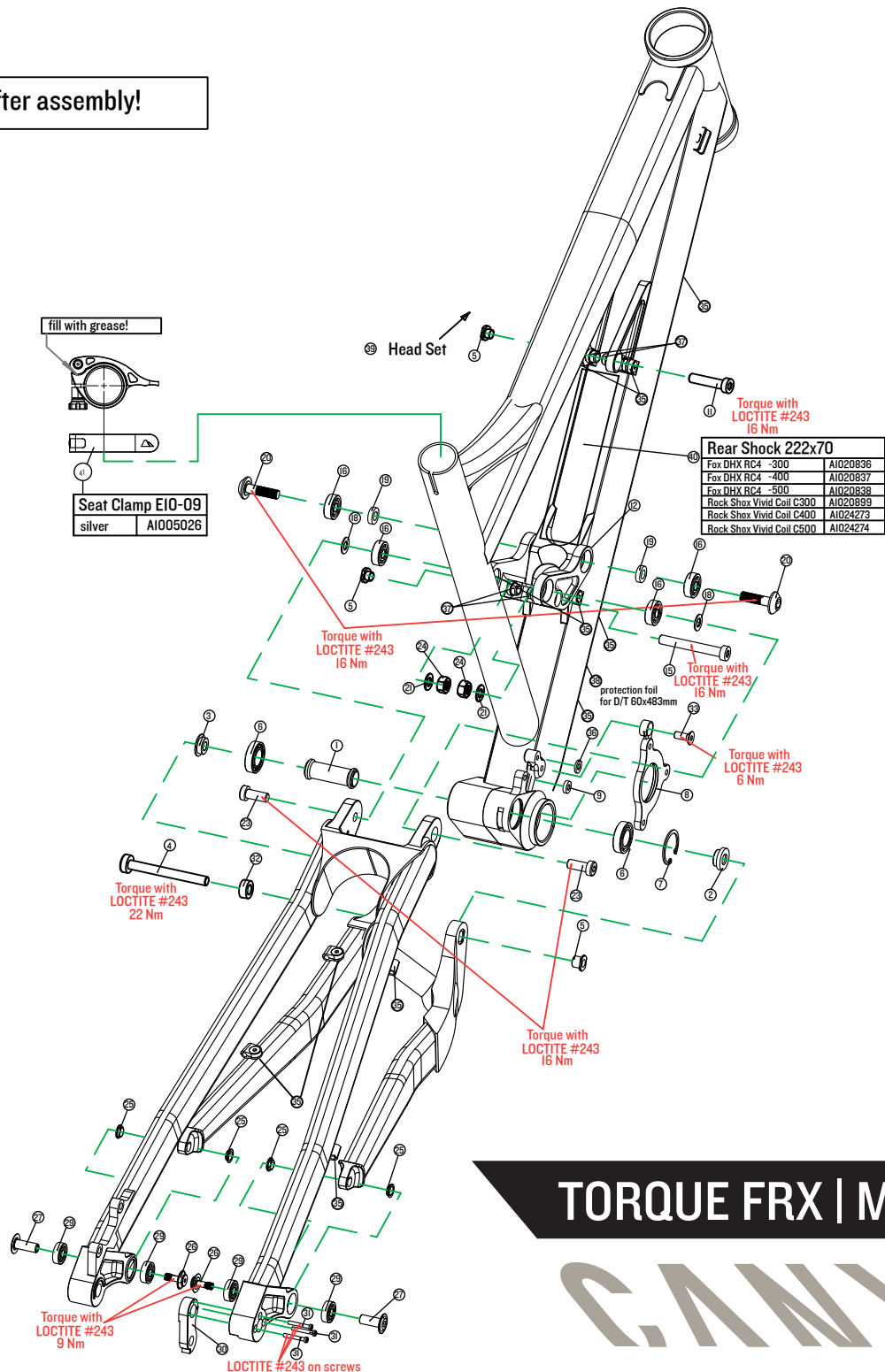

TORQUE FRX | M20-II

